

Ohlone College Newark Center on the 80-acre site showing some of the exterior "Green" features of the design. The campus opens in 2008 and will accommodate our health, sciences, and technology programs with the latest equipment and modern laboratories all housed in environmentally sustainable buildings.



David W. Smith  
Executive Director  
Asset Management

Email: dsmith@ohlone.edu  
Phone: 510.659.6441  
Fax: 510.659.6142

*A World of Cultures  
United in Learning*



Ohlone Community College District  
43600 Mission Boulevard  
Fremont, CA 94539-0390

Center for Health Sciences and Technology  
39399 Cherry Street  
Newark, CA 94560

Phone: 510.659.6000  
[www.ohlone.edu](http://www.ohlone.edu)

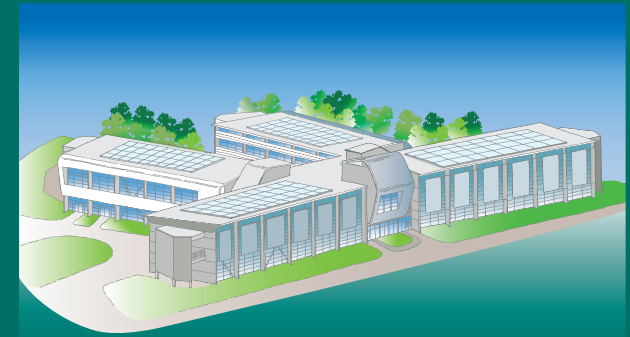

*College of the Future*  
Ohlone College Newark Center

Teaching  
"Green California"  
at the  
College  
of the  
Future



Printed on Recycled stock  
Brochure Design: Allen Graphic Design; Drawings by Allen Graphic Design and Perkins + Will

# Teaching “Green California” at the College of the Future!



*A new campus  
that teaches Energy Conservation  
and Environmental Sustainability  
...for California's future*

- The First “Green” Community College Campus in California and the Nation!
- The buildings are designed to achieve LEED Gold Certification.

## **A World of Cultures United in Learning**

### *About the Ohlone Community College District*

- 74% of our students are from ethnic minorities
- 18,000 students served annually
- Serving the cities of Fremont, Newark, and Union City for 40 years
- One of the top transfer community colleges in the state

### **Energy Conservation**

- Largest array of solar panels in Silicon Valley (providing 30% of our energy)
- Geothermal heating and cooling (provided by over four acres of ground coils)
- Fresh air transferred and filtered by enthalpy wheels (versus traditional HVAC)
- Exhibits and kiosks will demonstrate energy savings in “real time”

### **Environmental Sustainability**

- Buildings insulated with recycled denim
- Furniture is 60% to 99% recyclable
- “Machiche” Guatemalan hardwood harvested in accord with Forest Stewardship Council
- Brownfield reclamation site
- Largest “Bay-Friendly Landscaping” installation in the San Francisco Bay region
- Wetland restoration, creating a living, learning laboratory
- Storm water garden and bioswale collects and filters runoff water
- Green Purchasing practices in effect

### **Education**

- Environmental studies program with outdoor learning laboratory
- Retraining for displaced high tech workers providing immediate employment opportunities
- Focus on the emerging career of Biotechnology meeting employer's needs
- Outstanding Nursing program offered in association with various health care partnerships
- Industry partners advise faculty on needed worker skills to keep curriculum market-driven
- Latest classroom technology incorporated to enhance learning (wireless, distance learning, etc.)
- Research-based environments designed to optimize learning



*Ohlone College and Alameda County won the 2005 Recognition of Excellence Award from the Department of Labor for its displaced worker retraining program in the field of Biotechnology.*