

Ohlone Employee Wireless Connection Instructions

iOS iPhone Connection to Ohlone Employee Wireless

- Select Ohlone Employee

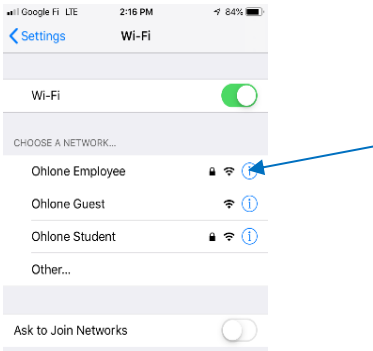

- Enter Webadvisor Username and Password then click 'Next'



- Tap 'Trust' for the certificate acceptance

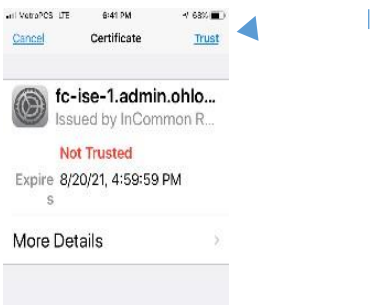

- Preferred web Browser will open; Scroll to the bottom of the Acceptable use Policy and click "Accept"

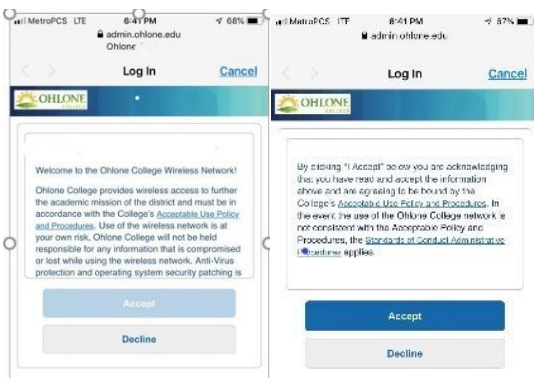

MacOS Connection to Ohlone Employee Wireless:

- Select Ohlone Employee Wifi and fill username and password with Webadvisor Username and Password

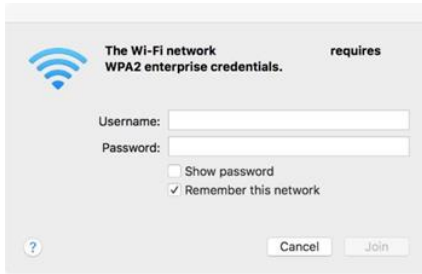

The Wi-Fi network requires WPA2 enterprise credentials.

Username:

Password:

Show password

Remember this network

Cancel Join

- Click 'show Certificate' and accept



Verify Certificate

Authenticating to network

Before authenticating to server "fc-ise-1.admin.ohlone.edu", you should examine the server's certificate to ensure that it is appropriate for this network.

To view the certificate, click 'Show Certificate'.

Show Certificate Cancel Continue

- Enter your computer's login name and password

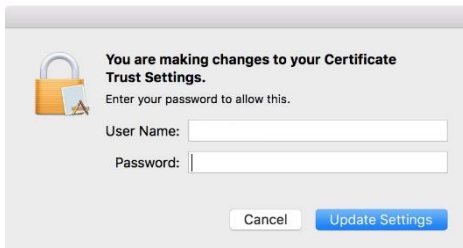

You are making changes to your Certificate Trust Settings.

Enter your password to allow this.

User Name:

Password:

Cancel Update Settings

- The preferred browser will open and display the acceptable use policy.
- Scroll to the bottom of the policy and click the enabled 'Accept' button



Welcome to the Ohlone College Wireless Network!

Ohlone College provides wireless access to further the academic mission of the district and must be in accordance with the College's [Acceptable Use Policy](#) and [Firewall Policy](#). Use of the wireless network is at your own risk. Ohlone College will not be held responsible for any information that is compromised or lost while using the wireless network. Anti-Virus protection and operating system security patching is the sole responsibility of the user and must be current before accessing the wireless network.

By clicking "Accept" below you are acknowledging that you have read and accept the information above and are agreeing to the Internet Use Policy, Acceptable Use Policy, and Firewall Policy. In the event the use of the Ohlone College network is not...

Accept Decline

- You are now connected



Connection Successful

You have successfully connected to the network.

Android Connection to Ohlone Employee Wireless:

- Select Ohlone Employee from list of Wireless Networks
- For Identity enter WebAdvisor Username and Password

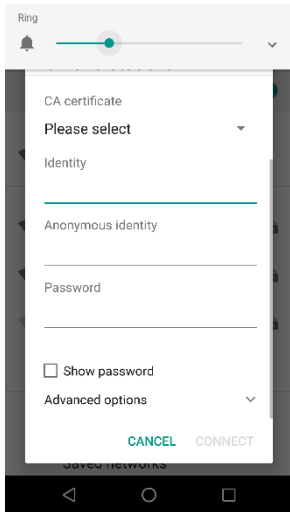

- Select the drop-down arrow below 'CA certificate' and select 'Do not Validate' for certificate
- Select 'Connect' to continue

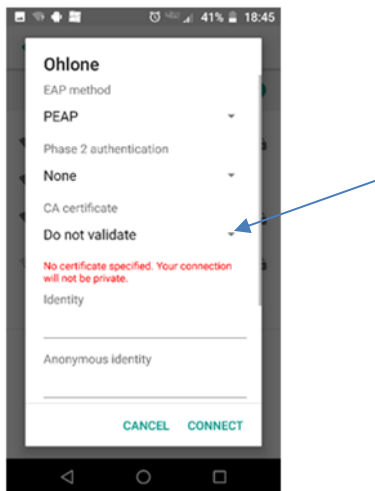

- Preferred web Browser will open; Scroll to the bottom of the Acceptable use Policy and click 'Accept'

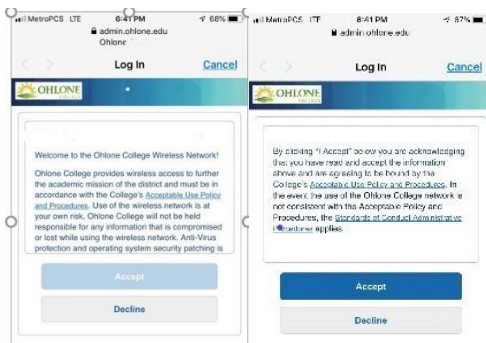

Windows Connection to Ohlone Employee Wireless

- Select Ohlone Employee then click 'Connect'



- Select 'Connect' button again on the "Continue connecting?" pop-up



- Enter your WebAdvisor Username and Password



- Web Browser will open with 'Acceptable User Policy'



- Scroll to the bottom of policy and click the 'Accept' button

